



Accessories

Connectors

Single Panel Mount Hardware, 425°F (218°C)

Rugged one-body design using thermocouple materials and spring loaded inserts, these units fit panels up to $\frac{7}{16}$ inch thick. Panel cutout: $1\frac{1}{8}$ inch to $1\frac{5}{32}$ inch hole. Units fit into standard $\frac{3}{4}$ inch knockouts.

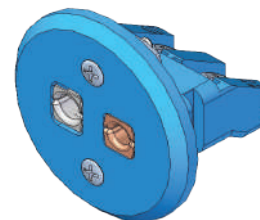

Ordering Information

Part Number

1 2 3	4	5	6 7
	Calibration	Name Plate	Color Code
SKP			

Calibration	
J =	Type J
K =	Type K
T =	Type T
Name Plate	
N =	Without name label
Color Code	
AT =	ASTM E 230 color code/uncompensated = white

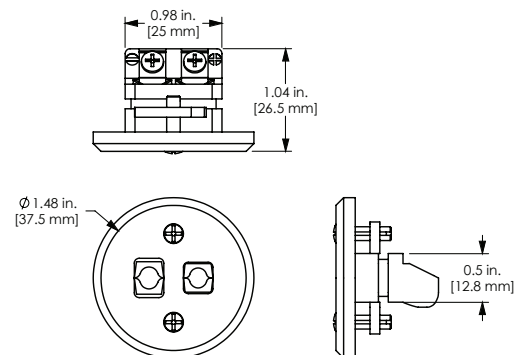

Weather Resistant Boots

Used in pairs as illustrated, these flexible neoprene rubber boots add moisture protection to standard plug-to-jack connections.

Part Number: **943**

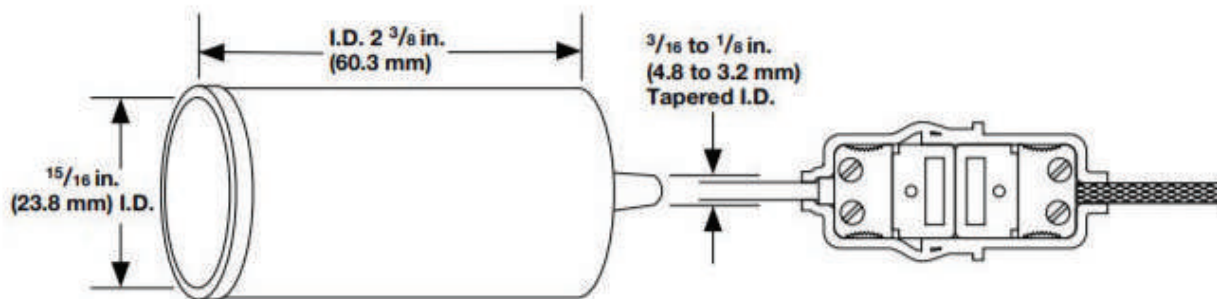

Note: All accessories are subject to minimum purchase quantities.