



EL-USB



Quick Start Guide

Windows™ 7/8/10 (32 & 64bit)



[Login: Create Account](#)
[info@lascar.com](#)
[+44\(0\)1753 784917](#)

[Home](#)
[Products](#)
[PowerMOS2 University](#)
[Learning Center](#)
[Software](#)
[Markets](#)
[News & Events](#)
[Partners](#)
[Help](#)
[Contact Us](#)
[Feedback](#)

[Home](#)
[Products](#)
[PowerMOS2 University](#)
[Learning Center](#)
[Software](#)
[Markets](#)
[News & Events](#)
[Partners](#)
[Help](#)
[Contact Us](#)
[Feedback](#)

EasyLog USB



[Download USB](#)
[Download USB for ARM](#)
[Download USB for Raspberry Pi](#)
[Download USB for Arduino](#)
[Download USB for STM32](#)
[Download USB for BeagleBone Black](#)
[Download USB for Raspberry Pi 4](#)
[Download USB for Raspberry Pi 5](#)
[Download USB for Raspberry Pi 6](#)
[Download USB for Raspberry Pi 7](#)
[Download USB for Raspberry Pi 8](#)
[Download USB for Raspberry Pi 9](#)
[Download USB for Raspberry Pi 10](#)
[Download USB for Raspberry Pi 11](#)
[Download USB for Raspberry Pi 12](#)
[Download USB for Raspberry Pi 13](#)
[Download USB for Raspberry Pi 14](#)
[Download USB for Raspberry Pi 15](#)
[Download USB for Raspberry Pi 16](#)
[Download USB for Raspberry Pi 17](#)
[Download USB for Raspberry Pi 18](#)
[Download USB for Raspberry Pi 19](#)
[Download USB for Raspberry Pi 20](#)
[Download USB for Raspberry Pi 21](#)
[Download USB for Raspberry Pi 22](#)
[Download USB for Raspberry Pi 23](#)
[Download USB for Raspberry Pi 24](#)
[Download USB for Raspberry Pi 25](#)
[Download USB for Raspberry Pi 26](#)
[Download USB for Raspberry Pi 27](#)
[Download USB for Raspberry Pi 28](#)
[Download USB for Raspberry Pi 29](#)
[Download USB for Raspberry Pi 30](#)
[Download USB for Raspberry Pi 31](#)
[Download USB for Raspberry Pi 32](#)
[Download USB for Raspberry Pi 33](#)
[Download USB for Raspberry Pi 34](#)
[Download USB for Raspberry Pi 35](#)
[Download USB for Raspberry Pi 36](#)
[Download USB for Raspberry Pi 37](#)
[Download USB for Raspberry Pi 38](#)
[Download USB for Raspberry Pi 39](#)
[Download USB for Raspberry Pi 40](#)
[Download USB for Raspberry Pi 41](#)
[Download USB for Raspberry Pi 42](#)
[Download USB for Raspberry Pi 43](#)
[Download USB for Raspberry Pi 44](#)
[Download USB for Raspberry Pi 45](#)
[Download USB for Raspberry Pi 46](#)
[Download USB for Raspberry Pi 47](#)
[Download USB for Raspberry Pi 48](#)
[Download USB for Raspberry Pi 49](#)
[Download USB for Raspberry Pi 50](#)
[Download USB for Raspberry Pi 51](#)
[Download USB for Raspberry Pi 52](#)
[Download USB for Raspberry Pi 53](#)
[Download USB for Raspberry Pi 54](#)
[Download USB for Raspberry Pi 55](#)
[Download USB for Raspberry Pi 56](#)
[Download USB for Raspberry Pi 57](#)
[Download USB for Raspberry Pi 58](#)
[Download USB for Raspberry Pi 59](#)
[Download USB for Raspberry Pi 60](#)
[Download USB for Raspberry Pi 61](#)
[Download USB for Raspberry Pi 62](#)
[Download USB for Raspberry Pi 63](#)
[Download USB for Raspberry Pi 64](#)
[Download USB for Raspberry Pi 65](#)
[Download USB for Raspberry Pi 66](#)
[Download USB for Raspberry Pi 67](#)
[Download USB for Raspberry Pi 68](#)
[Download USB for Raspberry Pi 69](#)
[Download USB for Raspberry Pi 70](#)
[Download USB for Raspberry Pi 71](#)
[Download USB for Raspberry Pi 72](#)
[Download USB for Raspberry Pi 73](#)
[Download USB for Raspberry Pi 74](#)
[Download USB for Raspberry Pi 75](#)
[Download USB for Raspberry Pi 76](#)
[Download USB for Raspberry Pi 77](#)
[Download USB for Raspberry Pi 78](#)
[Download USB for Raspberry Pi 79](#)
[Download USB for Raspberry Pi 80](#)
[Download USB for Raspberry Pi 81](#)
[Download USB for Raspberry Pi 82](#)
[Download USB for Raspberry Pi 83](#)
[Download USB for Raspberry Pi 84](#)
[Download USB for Raspberry Pi 85](#)
[Download USB for Raspberry Pi 86](#)
[Download USB for Raspberry Pi 87](#)
[Download USB for Raspberry Pi 88](#)
[Download USB for Raspberry Pi 89](#)
[Download USB for Raspberry Pi 90](#)
[Download USB for Raspberry Pi 91](#)
[Download USB for Raspberry Pi 92](#)
[Download USB for Raspberry Pi 93](#)
[Download USB for Raspberry Pi 94](#)
[Download USB for Raspberry Pi 95](#)
[Download USB for Raspberry Pi 96](#)
[Download USB for Raspberry Pi 97](#)
[Download USB for Raspberry Pi 98](#)
[Download USB for Raspberry Pi 99](#)
[Download USB for Raspberry Pi 100](#)

- Insert the data logger into an available USB port on your PC.
- Double click on the EasyLog USB icon on your Windows™ desktop. This will load the configuration software. Click 'Set up and start the USB data logger' and follow the set-up wizard.
- When setup is complete, the data logger should be removed from the USB port. **Do not leave your data logger in the USB port for extended periods as this will cause some of the battery capacity to be lost** (with the exception of EL-US-1-RCG).
- You can also download the data from a logger that has been recording or view previously saved data from the software.



REPLACING YOUR DATA LOGGER'S BATTERY

The logger is provided with a 3.6V 1/2AA battery already installed. You may replace the battery by following the instructions below.

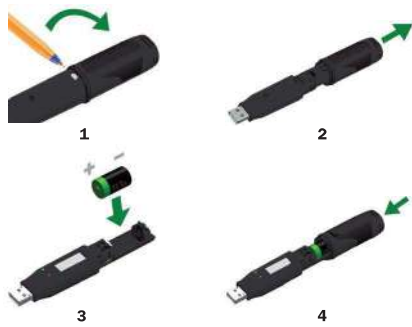

EL-USB-1 PRO

Before using the data logger you will need to insert the 3.6V 2/3AA High Temperature battery provided, following the instructions below.

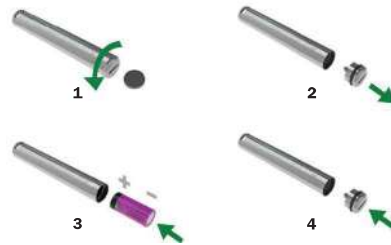

EL-USB-1-RCG

The EL-USB-1-RCG's battery is preinstalled. To charge the battery, connect to a USB port until the green LED shows. The rechargeable battery should only be replaced by an authorized supplier.

OUR RANGE

EL-USB

Simple Low Cost
Data Logging



- USB interface for configuration and download
- Easy to use Windows control software

EL-CC

Cold Chain Logistics
Loggers



- Low cost, reusable and waterproof
- Comes with pre-configured alarms

EL-GFX

Advanced Data Logging



- Graphic LCD for real-time readings and graph
- Compact and robust design

EL-WiFi

Wireless Data Logging



- Cloud based monitoring with email alerts
- Connects to an existing WiFi network

EL-MOTE

Cloud-based Data
Logging



- Cloud based monitoring from any internet enabled device
- Quick and easy set-up from smartphone App

Temperature



Temperature/
Relative Humidity



Voltage



Current



Event, State & Count



Thermocouple



Carbon Monoxide



Thermistor



IMPORTANT SAFETY INFORMATION



Repairing or Modifying

Never attempt to repair or modify Lascar products. Dismantling them, other than for the purpose of changing replaceable batteries, may cause damage that is not covered under the warranty. Servicing should only be provided by an authorized supplier.



Disposal and Recycling Information

You must dispose of Lascar products in accordance with relevant laws and regulations. They contain electronic components and lithium batteries and therefore must be disposed of separately from household waste.



Iss 12_05-2018