

AMPROBE®

ADPTR-KIT-1
ADPTR-E14
ADPTR-E27
ADPTR-GU10
ADPTR-B15
ADPTR-B22
ADPTR-SCT

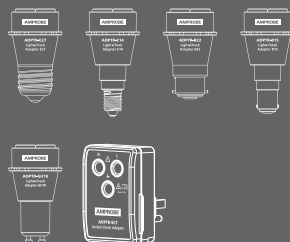

Light-check /
Socket-check adapter / incl. kit
Instruction Manual

ENG **FRE** **SPA**



ADPTR-KIT-1
ADPTR-E14
ADPTR-E27
ADPTR-GU10
ADPTR-B15
ADPTR-B22
ADPTR-SCT

English

Light-check /
Socket-check adapter / incl. kit
Instruction Manual

8/2018, 6010869 B
©2018 Amprobe
All rights reserved. Printed in China

Limited Warranty and Limitation of Liability

Your Amprobe product will be free from defects in material and workmanship for one year from the date of purchase unless local laws require otherwise. This warranty does not cover fuses, disposable batteries or damage from accident, neglect, misuse, alteration, contamination, or abnormal conditions of operation or handling. Resellers are not authorized to extend any other warranty on the behalf of Amprobe. To obtain service during the warranty period, return the product with proof of purchase to an authorized Amprobe Service Center or to an Amprobe dealer or distributor. See Repair Section for details. THIS WARRANTY IS YOUR ONLY REMEDY. ALL OTHER WARRANTIES - WHETHER EXPRESS, IMPLIED OR STATUTORY - INCLUDING IMPLIED WARRANTIES OF FITNESS FOR A PARTICULAR PURPOSE OR MERCHANTABILITY, ARE HEREBY DISCLAIMED. MANUFACTURER SHALL NOT BE LIABLE FOR ANY SPECIAL, INDIRECT, INCIDENTAL OR CONSEQUENTIAL DAMAGES OR LOSSES, ARISING FROM ANY CAUSE OR THEORY. Since some states or countries do not allow the exclusion or limitation of an implied warranty or of incidental or consequential damages, this limitation of liability may not apply to you.

Repair

All Amprobe returned for warranty or non-warranty repair or for calibration should be accompanied by the following: your name, company's name, address, telephone number, and proof of purchase. Additionally, please include a brief description of the problem or the service requested and include the test leads with the meter. Non-warranty repair or replacement charges should be remitted in the form of a check, a money order, credit card with expiration date, or a purchase order made payable to Amprobe.

In-warranty Repairs and Replacement – All Countries

Please read the warranty statement and check your battery before requesting repair. During the warranty period, any defective test tool can be returned to your Amprobe distributor for an exchange for the same or like product. Please check the "Where to Buy" section

Additionally, in the United States and Canada, in-warranty repair and replacement units can also be sent to an Amprobe Service Center (see address below).

Amprobe Light-Check Adapters enable ease-of-use with single-handed operation and ensure low contact resistance. Maintenance free, they feature small robust housings with an additional finger guard safety barrier. Light-Check Adapters are ideal for use with installation testers, insulation testers and wire tracers, as well as for voltage measurements and monitoring in power quality studies.

APPLICATIONS

The Adapters can be used in conjunction with a wide variety of test equipment that uses test leads terminating in 4 mm safety connectors. The Adapters enable a range of tests to be conducted on light fitting terminals and ensure a good, reliable and safe contact, eliminating the need to hold test probes in place.

ADPTR-KIT1 CONTENTS

The Light-Check Adapter Kit consists of a complete set of 5 Adapters (E27, B22, E14, B15, GU10) with carrying case.



ADPTR-E27
Light-Check
Adapter



ADPTR-E14
Light-Check
Adapter

Phase (red) and neutral (black) are marked on Adapters E27 and E14.

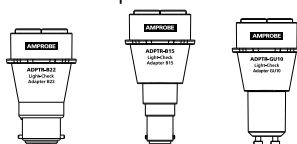

ADPTR-B22 Light-Check Adapter
ADPTR-B15 Light-Check Adapter
ADPTR-GU10 Light-Check Adapter

Phase and neutral are not marked for Adapters B22, B15 and GU10 due to the geometry of these sockets. Detect phase and neutral by using a suitable tester if necessary.

First connect test leads on the test device, then to the Adapter. Ensure correct connection of phase and neutral if required.

SOCKET-CHECK ADAPTER

1. Plug the adapter into the mains outlet to be tested.
2. The connections are marked as follows:
 - a. Black: Phase.
 - b. Red: Neutral.
 - c. Green: Earth.
3. Connect test leads first on the test device, then to the adapter. Ensure correct connection of phase, neutral and earth.
4. Conduct the test.

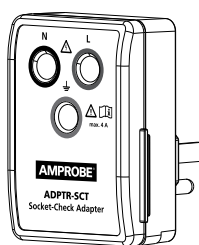

SYMBOLS

	Caution! Risk of electric shock
	Caution! Refer to the explanation in this manual
	Consult user documentation
	The equipment is protected by double insulation or reinforced insulation
	Earth ground
CAT II	Overvoltage category II is for equipment to be supplied from the building wiring
	Certified by CSA Group to North American safety standards
	Do not dispose of this product as unsorted municipal waste – contact a qualified recycler

SAFETY INFORMATION

The adapters comply with:
IEC/EN 61010-1 3rd Edition, UL61010-
1 3rd Ed. and CAN/CSA C22.2 No.
61010-1-12, pollution degree 2

⚠ ⚠ Warning

**To prevent possible electrical shock,
fire, or personal injury:**

- Read the operating instructions before use and follow all safety instructions.
- Comply with local and national safety codes. Use personal protective equipment (approved rubber gloves, face protection, and flame resistant clothes) to prevent shock and arc blast injury where hazardous live conductors are exposed.
- Use the adapters only as specified, or the protection supplied by the product can be compromised.
- Do not work alone.
- Do not use the adapters if they appear damaged. Examine the adapter for damaged insulation or exposed metal.
- Test the adapter's terminal continuity both before and after use to ensure the adapter is in good working condition.

- Do not apply more than the rated voltage and rated current.
- Do not touch voltages >30 V AC RMS, 42 V AC peak, or 60 V DC. These voltages pose electrical shock hazards. Keep fingers behind the finger guards of the adapter.
- Do not exceed the Measurement Category (CAT) rating of the lowest rated individual component of a product, probe, or accessory.
- If the adapter is used in a manner not specified in the user manual, the protection provided by the equipment may be impaired.
- Measurements can be adversely affected by impedances of additional operating circuits connected in parallel or by transient currents.
- Do not use the adapter with any of the parts removed.
- Do not use the adapter around explosive gas, vapor, dust or wet environments.

SPECIFICATIONS

Voltage range	Light-check adapter: 0 to 300 V AC Socket-check adapter: 0 to 120 V AC
Frequency range	50 Hz to 60 Hz
Max. current	Light-check adapter: 2 A Socket-check adapter: 4 A
Operating time	Continuous
Operating altitude	6561 ft (2000 m)
Operating temperature and humidity	32 °F to 104 °F (0 °C to 40 °C), ≤ 80% RH (without condensation)
Storage conditions	32 °F to 104 °F (0 °C to 40 °C), ≤ 80% RH (without condensation)
Drop proof	3.28 ft (1 m)
Pollution degree	2
Overvoltage category	Light-check adapters: CAT II 300 V Socket-check adapter: CAT II 120 V
Electrical safety	IEC 61010-1, UL61010-1, CAN/CSA C22.2 No. 61010-1-12
Agency approval	

Size (H x W x L)	ADPTR-E27: Approx. 2.8 x 1.6 x 1.2 in (70.8 x 40.4 x 31.3 mm) ADPTR-E14: Approx. 3.2 x 1.6 x 1.2 in (81.3 x 40.4 x 31.3 mm) ADPTR-B22: Approx. 2.7x 1.6 x 1.2 in (68 x 40.4 x 31.3 mm) ADPTR-B15: Approx. 3.1 x 1.6 x 1.2 in (78.8 x 40.4 x 31.3 mm) ADPTR-GU10: Approx. 2.9 x 1.6 x 1.2 in (74.7 x 40.4 x 31.3 mm) ADPTR-SCT: Approx. 2.95 x 1.97 x 2.56 in (75 x 50 x 65 mm)
Weight	ADPTR-E27: Approx. 0.06 lb (27 g) ADPTR-E14: Approx. 0.05 lb (23.5 g) ADPTR-B22: Approx. 0.06 lb (29.5 g) ADPTR-B15: Approx. 0.06 lb (25 g) ADPTR-GU10: Approx. 0.06 lb (29.5 g) ADPTR-SCT: Approx. 0.125 lb (0.057 kg)

CARE

The Adapters can be cleaned with a mild solution of soapy water. Apply sparingly with a soft cloth and allow to dry completely before using. Do not use aromatic hydrocarbons, gasoline, or chlorinated solvents for cleaning.