

# WÖHLER



## CAMERA TROLLEY FOR OPTIMAL VIEW

### Wohler VIS Camera Trolley

Flexibility in ductwork and pipes

*The Measure of Technology*



Made in  
Germany

1.800.561.8187

www.**itm**.com

information@itm.com

## Wohler VIS Camera Trolley

Positions the camera head perfectly in the pipe

A crisp image of every detail in the pipe: That is what perfect video inspection is all about. Wohler camera optics ensure crystal clear imagery. And the Wohler VIS Camera Trolley makes it possible to view every inch of the pipe or duct with ease. Clever details ensure it easily rounds every bend. No detail is overlooked during the inspection, because the camera head is always guided through the middle of the pipe.



The Wohler VIS Camera Trolley offers optimal guidance of the camera head in ventilation ducts, waster water pipes and flue gas lines from a size of 6" (circular & rectangular). The combination with the optional Wohler light ring and stabilization sleeve creates an even better illumination and increases handling in the pipe or duct. The best possible view in the pipe is guaranteed, because the Wohler camera trolley offers numerous adjustment options: The camera head is securely attached on the trolley or hangs protected below the trolley. That ensures the best possible clearance between the optics and the pipe walls. Regardless of how the camera head is attached to the trolley, you always keep control and get the best possible insight.

- ▶ Solid and durable stainless steel body
- ▶ Operates in challenging conditions
- ▶ Works with any Wohler camera head
- ▶ Adjustable camera head angle for a perfect view

## Premium flexibility



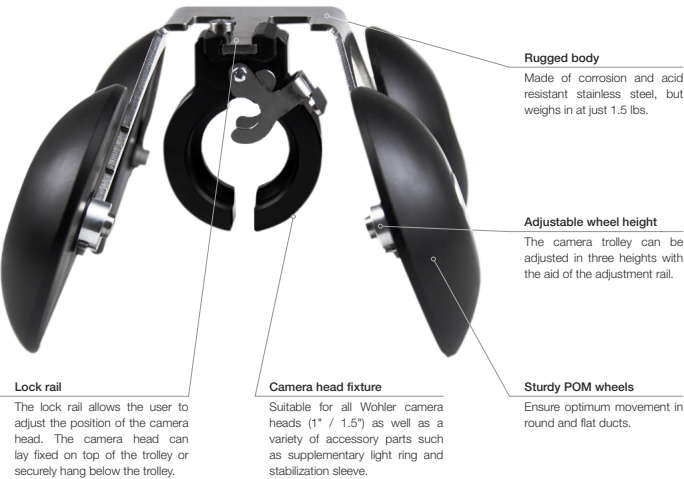

### Technical Data

Material of the trolley	Stainless steel
Material of the wheel	POM
Height (adjustable)	30" ... 35"
Width (adjustable)	5" ... 5.5"
Weight	1.5 lbs



Application examples		
Wohler miniature camera head 1" with supplementary light ring attached below the trolley.	Even in tilted position the camera head remains in operation.	Wohler pan- and tiltable camera head 1.5" with supplementary light ring and stabilization sleeve.

# Kits and accessories

Article description	P/N
 <p><b>Wohler VIS Camera Trolley</b> for camera heads</p> <p>Scope of delivery: Wohler VIS Camera Trolley, storage bag</p>	4705
 <p><b>Wohler VIS Camera Trolley Set</b> for camera heads</p> <p>Scope of delivery: Wohler VIS Camera Trolley, camerahead-holder, storage bag, stabilization sleeve for light ring (can only be used in combination with supplementary light ring)</p>	4753
 <p><b>Wohler Light Ring 1" / 1.5"</b> for camera heads 1" / 1.5"</p> <p>light ring with 18 white LEDs, outer 2.1", detachable</p>	8894
 <p><b>Wohler Light Ring 1" / 1.5" HD</b> for HD camera heads 1" / 1.5"</p> <p>light ring with 18 white LEDs, outer 2.1", detachable</p>	8818